

Installation Instructions

G15 & 2nd fix Rebate Frame with Integral Frame Adjusters

With appropriate fixings or DoorTechnik fitting kits, the G15 can be easily fitted to steel, masonry or timber openings. Please read these instructions before starting the installation.



Tel 01522 693522 Fax 01522 508494

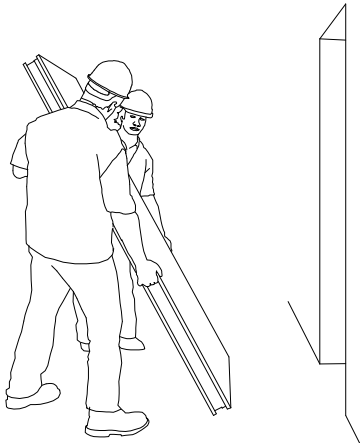

1. Place doorset in the opening.

Lift by the handgrips in the frame – never by lever handles, panic bars or letterboxes.

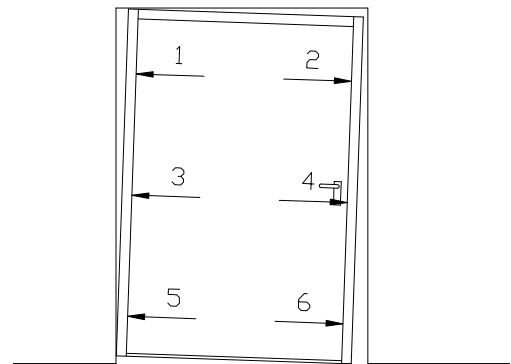

2. Align and grip the doorset in the opening, using the first six frame adjusting screws.

If the floor is not level, fit shims under the frame and threshold.

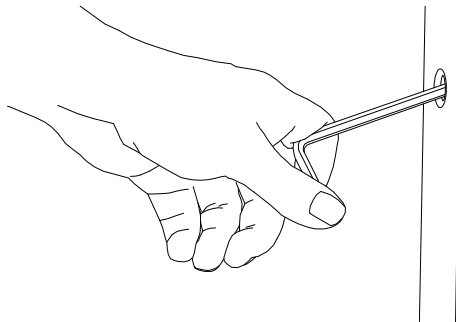

3. Tighten the six frame adjusters clockwise, with a 5mm ball-ended Allen key. Access is gained through the countersunk holes in the jambs, angling the key 20° from horizontal.

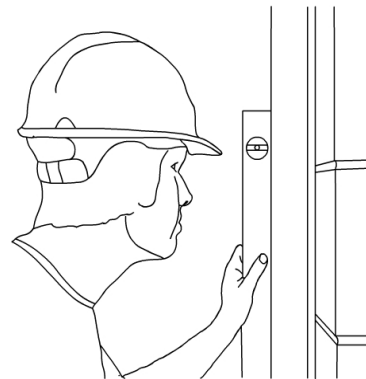

4. Check that doorset is vertical in both planes.

Do not open the door before the first six fixings are in place

The door has packings around all four edges, which eliminates movement between the door and frame, to ensure rapid fitting and stop alignment problems.

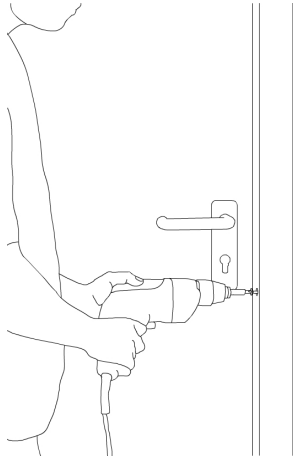

5. Fix through frame using the six long countersunk fixings.
Do not overtighten.

Fixing screws must be appropriate for the material of the building opening. We recommend:

Steel

ITW Buildex TFL 100 & TFL 80 or similar

Masonry

Rawl frame fixings 8 x 120 & 8 x 100 or similar

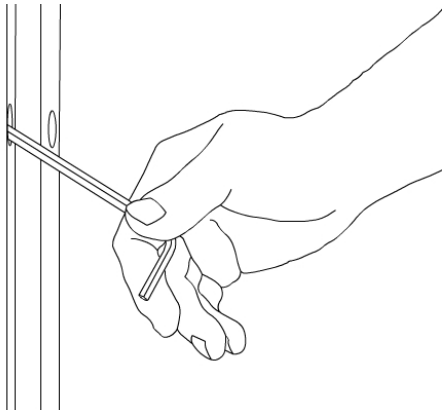

6. Open the door and discard the transit packings.

Tighten the next six frame adjusters in the reveals.

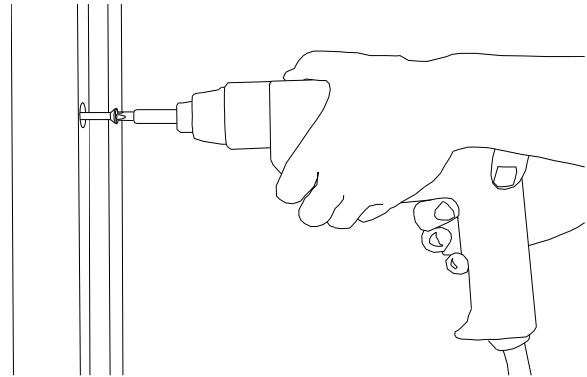

7. Fix through frame reveals with short countersunk screws. Do not overtighten

8. Fix threshold to floor with countersunk screws. Do not overtighten.
9. Check operation of all locking mechanisms and closing devices.
10. If required, apply mastic or flashings to seal frame to building.
11. Seal threshold to floor to avoid water ingress.

Fitting into Masonry

- Masonry frames have correctly sized holes to suit DoorTechnik masonry fixings. Standard frames may be fitted to masonry, if the holes in the frame brackets are drilled out prior to fitting.
- Vibration from a hammer drill can loosen the frame adjusting screws. Re-check tightness of the screws prior to inserting the frame fixings.
- When fixings will fall into the cavity, pre-fix cavity bridging plates to the wall, then use Tek screws to fasten the doorframe to the bridging plates.
- If the frame fixings are not secure enough, injecting expanding foam behind the frame will help.

Fitting before the floor is laid

Install temporary supports – blocks, timber, etc to support the bottom of the frame at the correct height, then install as normal. The fixings in the jambs are strong enough to hold the doorset until the floor is laid.